

SUNSEEKER 37 METRE YACHT

STYLE: TRI DECK LUXURY YACHT

ACCOMMODATION: UP TO 10 GUESTS AND 7 CREW MEMBERS

PERFORMANCE: UP TO 24 KNOTS

LAUNCHED IN 2007 AND A SIGNIFICANT STEP IN SCALE FOR CONSTRUCTOR AND CLIENT, THE 37 METRE YACHT IS THE FIRST OF SUNSEEKER'S TRI DECK YACHTS. THAT'S THREE DECKS INTERNALLY, NOT COUNTING THE ADDITIONAL SKY DECK ABOVE, MARKING A MOVE INTO A NEW LEVEL OF YACHTING. FOR THE OWNER'S PARTY OF UP TO TEN THERE ARE FOUR LOWER DECK GUEST CABINS PLUS A FULL BEAM MAIN DECK MASTER SUITE. THERE ARE LOUNGE SALOONS ON BOTH MAIN AND UPPER DECKS, NUMEROUS PRIVATE AREAS FOR QUIET SOCIALISING, AND A GARAGE FULL OF FAST TOYS FOR THOSE VIGOROUS MOMENTS. A WELL PROVIDED-FOR CREW OF UP TO SEVEN TENDS TO NEEDS, AND FROM BRIDGE TO ENGINE ROOM WITH ALL BETWEEN, THE SHIP'S EXTENSIVE MANAGEMENT SYSTEM IS FULLY COMPUTERISED.

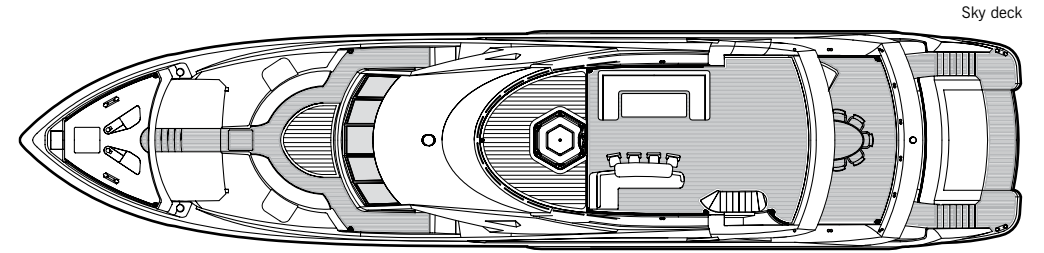

Sky deck

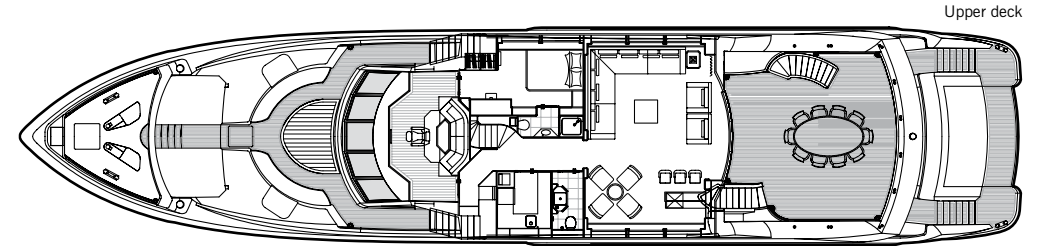

Upper deck

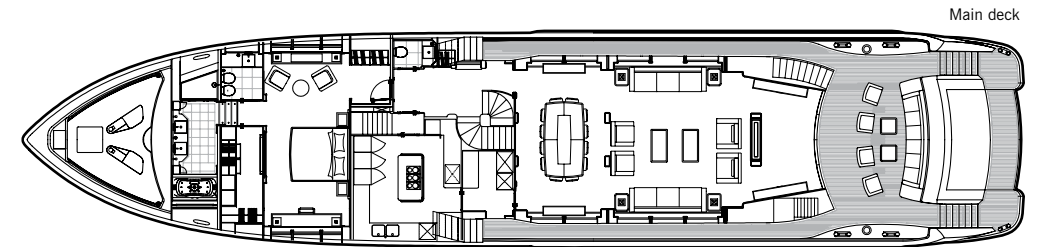

Main deck

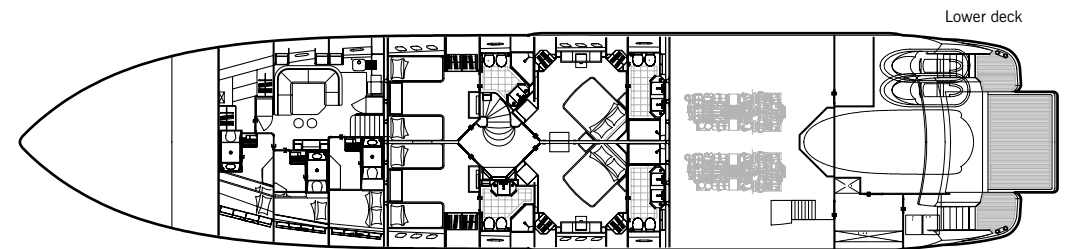

Lower deck

PRINCIPAL CHARACTERISTICS

Length overall	36.89m	121'0"
Length waterline – (@ normal half load)	31.19m	102'4"
Beam maximum – (incl. topside fender strakes)	8.00m	26'3"
Height from waterline to top of arch	9.50m	31'2"
Draft – (@ full load)	2.25m	7'4"
Displacement – (@ light load)	165000kg	363763lb †
Displacement – (@ normal half load)	175000kg	385809lb †
Displacement – (@ full over load)	190000kg	418878lb †
Standard fuel load capacity	22000 litres	5812 US gal.
Optional overload tank capacity	5800 litres	1532 US gal.
Total long-range capacity – (with optional tank)	27800 litres	7345 US gal.

† subject to final specification

Other layout options available

Fresh-water capacity	4950 litres	1307 US gal.
Black-water capacity	1450 litres	383 US gal.
Grey-water capacity	1350 litres	356 US gal.
Propulsion	2 x fixed pitch propellers	
Engine options	up to 5624 PS	
Generators	2 x 70kW 400/230V 3 phase 50Hz (Euro) 2 x 80kW 400/230V 3 phase 60Hz (US)	
Maximum speed – (@ normal half load, with extended tank)	up to 24 knots (subject to engine option)*	
Maximum range – (@ normal half load, with extended tank)	up to 1500 nautical miles (@ 10-12 knots)*	

All principal characteristics and specifications are provisional.



SUNSEEKER 37 METRE YACHT





1. Upper deck
2. The Sunseeker 37 Metre Yacht at anchor
3. The Sunseeker 37 Metre Yacht 'The Snapper'
4. Main saloon and dining area on 'Tickled Pink'
5. Guest double cabin
6. Day head
7. Sumptuous galley
8. Master stateroom through to walk-in wardrobe and en suite on 'M4'



Krüger Werft AG
Ländlistrasse 28
CH-8274 Gottlieben
Tel. +41(0)71 6691269
info@krueger-werft.ch

Awards

Sunseeker's success over the years is clearly underlined by the following list of national and international awards and achievements.

2008	UK Motor Boat of the Year Awards 2008	Manhattan 60	2001	Best Power Interior Award	105 Yacht, The Superyacht Society
2007	European Powerboat of the Year	Superhawk 43	2001	President's Award	Southern California Marine Association
2007	Asia Pacific Boating Awards	90 Yacht, Best of the Best	2000	Queen's Award for Enterprise	Continuous innovation and development
2007	Modern Boating Magazine 2007	Portofino 47, Imported Powerboat of the Year	2000	The Times Exporter of the Year	Times Export Awards
2007	Australian Marine Industries Federation Awards	Predator 62, Imported Powerboat of the Year	2000	Robb Report Award	Best of the Best, Boating and Sailing
2007	Nominated by The Superyacht Society	37 Metre Yacht 'The Snapper'	1999	Robb Report Award	Best of the Best, Boating and Sailing
2007	Queen's Award for Enterprise	International Trade	1999	Motorboat of the Year	Predator 75, BT British Nautical Awards
2006	Nominated for three Superyacht Awards	Predator 108 'SHIVER'	1998	Superyacht Design Award	Manhattan 74, Superyacht Design Awards
2005	Australian Marine Industries Federation Awards	75 Yacht, Non-Trailable Boat Award	1998	Editor in Chief Awards	Yachts Magazine
2005	Australian Marine Industries Federation Awards	Portofino 46, Commendation	1997	Lifetime Achievement Award	Robert Braithwaite MBE, RYA Awards
2005	Modern Boating, Power Boat of the Year Awards	Predator 68, Imported Powerboat of the Year	1996	Motorcruiser of the Year Award	RYA British Nautical Awards
2005	Boats.com Marine Industry Web Awards	Manufacturers Category for www.sunseeker.com	1996	Exporter of the Year Award	DCCI Export Awards
2004	Sydney Boat Show 2004	Best Overall Display	1995	Boat Builder of the Year Award	RYA/BMIF British Nautical Awards
2004	Sydney Boat Show 2004	Best Marina Display	1994	Queen's Award for Export Achievement	Queen's Awards for Industry
2003	Australian Marine Awards	Manhattan 56, Award for Excellence	1992	Best in the World Award	Renegade 60, Boating Magazine
2003	Australian Marine Awards	Predator 68, Best Imported Non-Trailable Yacht	1990	Exporter of the Year	SW International Business Awards
2002	Entrepreneur of the Year Award	Robert Braithwaite MBE	1989	Queen's Award for Export Achievement	Queen's Awards for Industry
2001	Best Power Design Award	105 Yacht, The Superyacht Society	1987	Queen's Award for Export Achievement	Queen's Awards for Industry

Naval architects

Don Shead/Sunseeker Design

Exterior styling

Sunseeker Design

Interior design

Sunseeker Design

Builder

Sunseeker International

*Every attempt has been made to give accurate information, but performance and range figures are estimates given as a guide only. Dirt or growth on the hull, tuning of the engines, size, make of engines fitted, damage to propellers, the temperature of the air and water, the weight of fuel, water, stores, number of people, propeller pitch, quality of fuel and other matters, can all affect a boat's performance and range. For these and other reasons we can give no performance, range or other guarantees, and neither such guarantees nor anything contained herein constitutes an offer of contract or any representation or agreement, or may otherwise be relied upon. The photographs and artist's impressions in this brochure are of existing models in the Sunseeker range. There may be items shown in these photographs and artist's impressions that are not included in the standard inventory of the models shown. Specifications contained on the web site are samples only and should not be relied upon and may refer to models only intended for sale in a particular territory and not generally. No guarantee is given that any model will be available in any territory; however by contacting us we can advise you of models that are likely to be available in each territory. Actual specifications will be provided when a sales order or enquiry is placed with us or our approved Sunseeker dealer. Specifications for models sold in different markets may vary and specifications and models may be changed or withdrawn at any time without prior notice. The individual specification for each vessel will be agreed as part of the sale contract between the purchaser and the Sunseeker dealer. Dealers and distributors are independently owned and operated entities, and therefore Sunseeker dealers and distributors are not owned by Sunseeker International Limited or any subsidiaries or other related entity of this company nor are they their agents. Therefore they have absolutely no authority to commit Sunseeker International Limited, or any subsidiary or other related entities of Sunseeker International Limited to any pledge, contract or agreement in any form or by any means unless first accepted in writing by Sunseeker International Limited. In some examples herein Sunseeker have referred to measurements, specifications or other details applicable to a particular territory and no guarantee is given that these are applicable to your territory. For ease of reference we have, in some cases, referred to "we" or "Sunseeker" and these terms should be taken to mean Sunseeker International Limited.

Designed, written and produced by Marketing Matters Limited. Printed in England. August 2008. ©Sunseeker International.



Sunseeker International Limited has
CE Approval which is compulsory
for all boats with a LOA of 24m and
below when sold in the EU.