

# SUNSEEKER 90 YACHT

**STYLE:** LUXURY YACHT

**ACCOMMODATION:** UP TO 8 GUESTS AND 4 CREW MEMBERS

**PERFORMANCE:** UP TO 30 KNOTS

STYLED IN GOOD SPORTING VEIN, THE 90 YACHT PROVIDES A POWERFUL, VERSATILE OPTION FOR OWNERS WHO MIGHT NOT ONLY WANT FULLY CREW-SERVICED OPERATION BUT ALSO FOR THOSE WHO WANT THE WHOLE BOAT FOR FAMILY AND FRIENDS. HOW SO THE OPTION? SPACE AFT OF THE ENGINE ROOM CAN BE EITHER CREW QUARTERS FOR 4 OR DEDICATED TO HOSTING WATER TOYS WITH AUTO-LOWERING STERN PLATFORM FOR SIMPLE SLIPPING... AND, OF COURSE, CREATING YOUR OWN 'BEACH'. THE ACCOMMODATION PLAN BUILDS OUT FROM THE MAIN DECK CENTRE SALOON WITH STAIRCASE LEADING TO TWO TWIN GUEST CABINS AND MASTER SUITE BELOW AND VIP SUITE FORWARD.

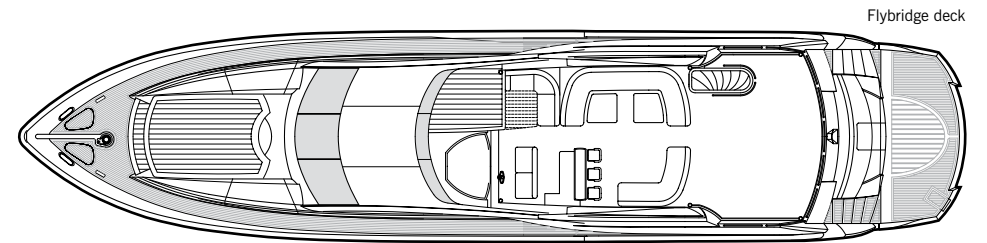
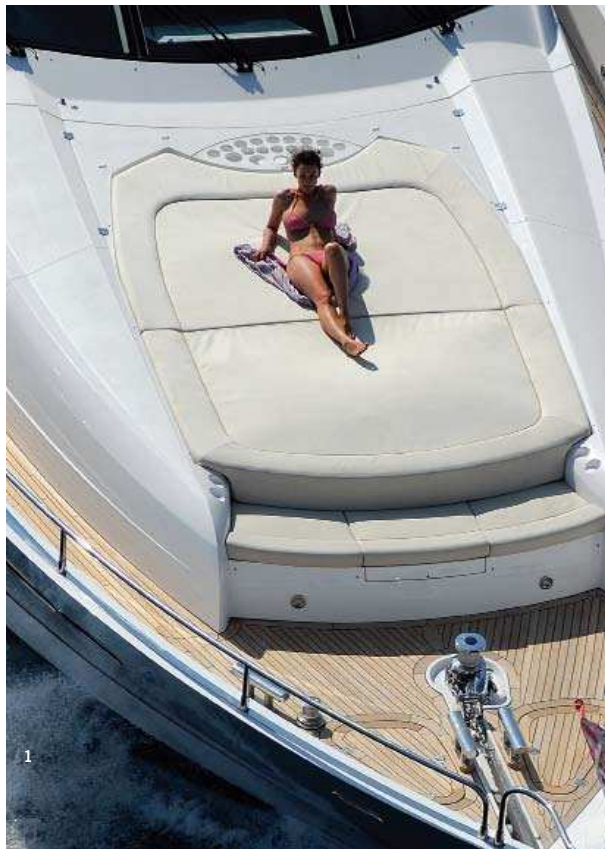

Flybridge deck

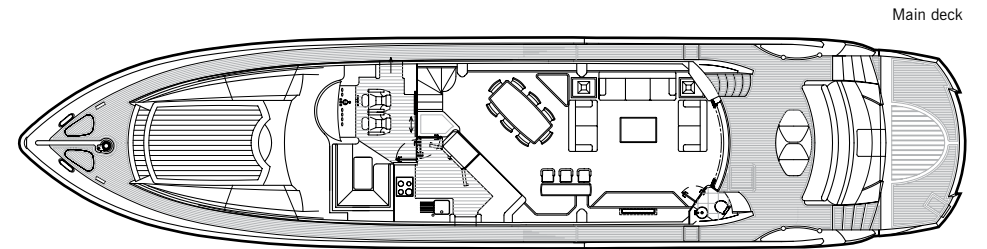

Main deck

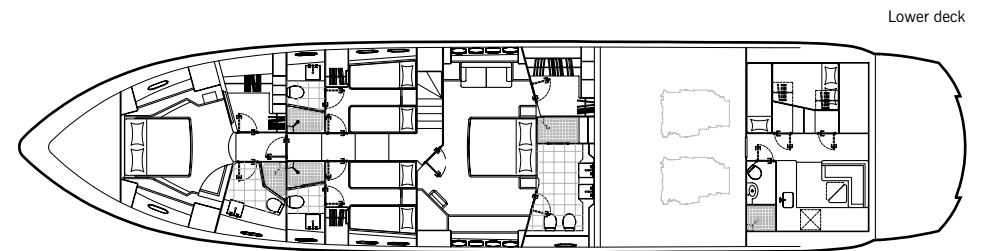

Lower deck

## PRINCIPAL CHARACTERISTICS

<b>Length overall – (incl. pulpit and platform)</b>	28.00m	91'11"
<b>Length waterline – (@ half load)</b>	20.29m	66'7"
<b>Beam – (maximum)</b>	6.30m	20'8"
<b>Draft – (@ full load incl. props)</b>	2.00m	6'7"
<b>Displacement – (@ half load)</b>	71000kg	156628lb
<b>Fuel capacity</b>	8500 litres	1870 GB gal. 2246 US gal.
<b>Fresh-water capacity</b>	1500 litres	330 GB gal. 396 US gal.

<b>Propulsion</b>	2 x submerged props in semi-tunnels
<b>Engine options</b>	up to 3650 PS (total)
<b>Fuel options</b>	Diesel
<b>Maximum speed</b>	up to 30 knots (subject to engine option)*
<b>Range</b>	up to 450 nautical miles (subject to engine option)*

All principal characteristics and specifications are provisional.



# SUNSEEKER 90 YACHT

## GENERAL CONSTRUCTION

Built to European specification 220v single phase 50Hz  
or  
Built to USCG Regulations 220v/110v single phase 60Hz

Air conditioning  
Hydraulic lifting platform  
Electric winch with foredeck control  
Side opening wheelhouse and galley access doors  
Hot and cold swimming shower at stern  
Power-assisted steering at wheelhouse and flybridge helm positions  
Flybridge wetbar with sink, ice maker, fridge and griddle  
Flatscreen televisions in saloon, all guest cabins and crew mess  
Hi-fi surround-sound system DVD/CD/radio in saloon and master stateroom  
Electric refrigerator, freezer and ice maker  
Ceramic hob, microwave/oven and dishwasher  
Electronic depth and speed displays  
Radar/chartplotter with GPS  
Autopilot  
VHF radio (dual station)  
Hot and cold water system  
Fresh-water pump  
Toilet system with holding tank  
Automatic fire extinguishing system for engine room  
Automatic bilge pumps  
Slow speed generators with underwater silent exhausts  
AC shorepower/battery charger  
Bow thruster  
Stern thruster  
Trim tabs  
Fire detection system  
Remote controlled spotlight at bow  
Deckwash with outlets forward, aft and flybridge  
Fresh-water marina connection  
Teak bathing platform and steps  
Teak side decks  
Teak cockpit floor  
Screen demisters  
Stern winches  
Antifouling

All items included in standard specification.

USA specification includes:  
Upgraded generators  
US Coast Guard build regulations  
US specification appliances

## STANDARD SPECIFICATIONS

### 1 Construction

Hand-laid GRP  
Gel coat including stripes  
Vinylester skin coat with powderbound mat  
Stitched multi-axial reinforced single skin bottom  
Balsa cored hull topsides  
PVC foam cored deck and superstructure  
Hull stiffened with longitudinal stringers supported by transverse bulkheads and floors

### 2 Deck

Three pairs of spring cleats with chafing bars  
Pair of bow cleats and fairleads  
Fittings in stainless steel  
Pair stern cleats and fairleads  
Pulpit and cockpit rails  
Stainless steel bow roller with anchor stop  
Stainless steel bow plate  
Automatic fresh-water chain wash  
Fresh-water deckwash with outlets forward and aft  
Chain locker  
Curved direct glazed safety glass windscreen  
Pantograph windscreen wipers and washers  
Fuel fillers port and starboard  
Fresh-water filler  
IMCO navigation lights  
Remote controlled spotlight at bow  
Low-level courtesy lights on side decks 24v  
Ensign staff and socket  
Bow seat and sunbathing pad  
Teak laid sidedecks  
80kg galvanised anchor  
100m of anchor chain, 14mm diameter (galvanised)  
Electric winch and capstan with foredeck controls  
Escape hatch to foredeck from VIP stateroom

### 3 Flybridge

Acrylic deflecting spray screen  
Seating areas  
Storage lockers under seating  
Teak dining table with GRP base  
Upholstered sunbathing area forward  
Stainless steel aft safety rails  
Glass holders  
Fire extinguisher in wetbar locker  
Deckwash outlet  
Low-level flybridge lighting 24v  
Radar arch structure  
Two pairs of marine speakers connected to CD/radio in saloon  
Wetbar with sink  
Ice maker in wetbar  
Fridge in wetbar  
Ceramic griddle in wetbar  
Bar stools X 3  
Self-draining cockpit

### 4 Flybridge helm position

Bench seat  
Hydraulic steering  
Autopilot repeater  
Radar/chartplotter with GPS repeater (1 x display)  
Depth and speed multi display  
VHF second station  
Remote spotlight control  
Manual compass  
Steering indicator  
Trim tab control  
Horn control  
Instrument cover  
Radio/CD remote keypad  
Waterproof plug and socket 12v  
Duplicate engine throttle controls  
Analogue engine instrumentation

### 5 Aft cockpit

Teak laid cockpit floor  
Self-draining  
Stairs to flybridge with teak treads  
Aft fixed bench seating  
Teak table with folding leaves on GRP base  
Stern safety gates  
Engine room access hatch  
2 x stern capstan winches 24v and fairleads  
Overhead cockpit lights 24v  
Low-level courtesy lights 24v  
Pair marine speakers connected to flybridge CD/radio system  
Fire extinguisher in seat base  
Aft rope lockers  
Dockside AC connection  
Battery switches in locker

### 6 Bathing platform

Stairs to aft cockpit with teak treads  
Teak-laid hydraulic lifting bathing platform  
Fold out stainless steel swimming ladder  
Access door to crew quarters  
Hydraulic telescopic gangway  
Hot and cold hand-held swimming shower  
Fresh-water marina connection  
Telephone marina connection  
Starboard side door to lazarette

### 7 Boat covers

Windscreen sun screen  
Flybridge instrument cover  
European specification only: Aft cockpit camper with windows



## 8 Main saloon and dining

Stainless steel framed sliding patio door to aft cockpit with curtains and tie back  
Control head for flybridge CD/radio system  
Air-conditioning  
Side windows with blinds  
Halogen overhead lighting 24v  
Double AC sockets  
Telephone point (aft port side)  
2 x table lamps  
Coffee table  
Sofa seating in aft saloon with scatter cushions  
Dining table  
Eight free-standing dining chairs  
Bar with granite top  
Three bar stools  
Drinks cabinet with glassware stowage for eight (8 x Champagne, 8 x whisky, 1 x decanter)  
LCD flatscreen television (42") on rise & fall  
DVD/CD/radio surround sound entertainment system (five speakers and sub-woofer)  
Sensor connected to fire detection system  
iPod docking station connected to surround sound system

## 9 Day head

Tecma toilet 24v  
Granite floor  
Washbasin  
Taps and accessories  
Mirror  
Extractor fan  
Halogen overhead lighting 24v

## 10 Galley

American style fridge/freezer with ice maker  
4-ring ceramic hob AC  
Hob extractor AC  
Slimline dishwasher AC  
Stainless steel sink  
Rubbish bin  
8 place crockery set  
8 place cutlery set  
Storage consisting of cupboards, drawers and top-box lockers  
Halogen overhead lighting 24v  
Spotlights under top box lockers  
Double AC sockets  
Fire extinguisher  
Fire blanket  
First aid kit  
Side opening door to port sidedeck  
Telephone point  
Sensor connected to fire detection system  
European specification only: Microwave/oven AC  
USA specification only: Oven AC  
USA specification: Small microwave AC

## 11 Wheelhouse

2 x upholstered helm seats  
Sofa seat  
Double AC sockets  
2 x telephone points  
Console with walnut effect fascia  
Hydraulic power steering  
Wooden rimmed steering wheel  
Radar/chartplotter with GPS (2 x displays)  
Autopilot  
Depth and speed displays  
VHF radio dual station  
Manual compass  
Horn control  
Switch panels  
Remote spotlight control  
Trim tab controls  
Rudder indicator  
Full analogue engine instrumentation  
Fresh-water gauge  
Fuel gauge  
Cigar lighter  
Main control panel (AC/DC) with generators control  
Monitoring panel for fire detection system  
Screen demister  
Glass holder  
Fire extinguisher  
Table with chart stowage  
Side opening door to starboard side deck  
Windscreen wipers with washers  
Sensor connected to fire detection system  
Doors to galley and saloon area

## 12 Lower Lobby

Halogen overhead lighting 24v  
AC socket  
Bilge access hatches  
Doors to guest cabins  
Fitted carpet  
Sensor connected to fire detection system

## 13 Master aft stateroom

Double berth  
Foam mattress for berth  
Storage beneath berth  
Drawers in base sides  
Bedside units with storage  
Bedside lights AC  
Dressing table with mirror and low-back chair  
Two-seater settee  
Air-conditioning  
Halogen overhead lighting 24v  
2 x table lamps  
4 x large vertical portholes with blinds each side (opening portholes with mosquito screens)  
Double AC sockets  
2 x telephone points (dressing table and starboard bedside table)  
LCD flatscreen television (42")  
DVD/CD/radio entertainment system with two speakers and sub-woofer  
Door to en suite toilet/shower room and walk-in wardrobe  
Fitted carpet  
Sensor connected to fire detection system

## 14 Master stateroom walk-in wardrobe

Hanging rails  
Drawers  
Shelves  
Full-length mirror  
Halogen overhead lighting 24v  
Fitted carpet  
Door to stateroom

## 15 Master stateroom en suite

Tecma toilet 24v  
Bidet  
Granite vanity top and flooring  
Twin washbasins  
Taps and accessories (toothbrush and glass holder, soap dish, towel rails and towels)  
Large shower  
Extractor fan  
Air-conditioning outlet  
Mirrors  
Halogen overhead lighting 24v  
Opening porthole with mosquito screen and Venetian blind  
Shaver socket 240/110v  
Door to stateroom

## 16 Port guest cabin

Two single berths  
Table with chart stowage  
Foam mattresses for berths  
Under berth stowage  
2 x reading lights 24v  
Bedside unit with storage  
Wardrobe  
Air-conditioning  
Halogen overhead lighting 24v  
Three vertical portholes (centre opening with mosquito screen) and blind  
Double AC sockets  
LCD flatscreen television (19")  
DVD/CD player with two speakers  
Telephone point (beside bedside table)  
Fitted carpet  
Door to en suite and lobby  
Sensor connected to fire detection system

## 17 Port guest cabin en suite

Tecma toilet 24v  
Granite vanity top and flooring  
Washbasin  
Taps and accessories (toothbrush and glass holder, soap dish, towel rails and towels)  
Separate shower compartment  
Acrylic shower door  
Extractor fan  
Air-conditioning outlet  
Mirrored vanity unit  
Shelved cupboard  
Halogen overhead lighting 24v  
Opening porthole with mosquito screen and Venetian blind  
Shaver socket 240/110v  
Door to guest cabin

## 18 Starboard guest cabin

Two single berths  
Foam mattresses for berths  
Under berth stowage  
2 x reading lights 24v  
Bedside unit with storage  
Wardrobe  
Air-conditioning  
Halogen overhead lighting 24v  
Three vertical portholes (centre opening with mosquito screen) and blind  
Double AC sockets  
Door to en suite toilet/shower room  
LCD flatscreen television (19")  
DVD/CD player with two speakers  
Telephone point (beside bedside table)  
Fitted carpet  
Doors to en suite and lobby  
Sensor connected to fire detection system

## 19 Starboard guest cabin en suite

Tecma toilet 24v  
Granite vanity top and flooring  
Washbasin  
Taps and accessories (toothbrush and glass holder, soap dish, towel rails and towels)  
Separate shower compartment  
Acrylic shower door  
Extractor fan  
Air conditioning outlet  
Mirrored vanity unit  
Shelved cupboard  
Halogen overhead lighting 24v  
Opening porthole with mosquito screen and Venetian blind  
Shaver socket 240/110v  
Door to guest cabin

## 20 Forward VIP stateroom

Double berth  
Foam mattress for berth  
Storage beneath berth  
Drawers in berth-end  
Bedside lights 24v  
Dressing table with stool  
Sofa  
Air-conditioning  
LCD flatscreen television (42")  
DVD/CD player with two speakers  
Halogen overhead lighting 24v  
Opening portholes with mosquito screen and Roman blinds  
Escape hatch to foredeck  
Double AC socket  
Telephone point x 2 (port bedside and dressing table)  
Door to en suite toilet/shower room and walk-in wardrobe  
Fitted carpet  
Sensor connected to fire detection system

## 21 Forward VIP walk-in wardrobe

Hanging rails  
Drawers  
Shelves  
Full-length mirror  
Halogen overhead lighting 24v  
Fitted carpet  
Door to stateroom

## 22 Forward VIP en suite

Tecma toilet 24v  
Granite vanity top and flooring  
Washbasin  
Taps and accessories (toothbrush and glass holder, soap dish, towel rails and towels)  
Separate shower compartment  
Acrylic shower door  
Air-conditioning outlet  
Extractor fan  
Mirrored vanity unit  
Shelved cupboard  
Halogen overhead lighting 24v  
Opening porthole with mosquito screen and Venetian blind  
Shaver socket 240/110v  
Door to stateroom

## 23 Crew mess

Access door from stern  
Storage  
Sink  
Air-conditioning  
AC sockets  
Extractor fan  
Microwave  
Sofa and table  
LCD flatscreen television (19")  
DVD/CD player with two speakers  
Non-slip flooring  
Engine room access door  
Halogen overhead lighting 24v  
Sensor connected to fire detection system  
Small fridge  
Washer/dryer AC  
Telephone socket  
Opening porthole with mosquito screen and Venetian blind  
Door to crew cabins and toilet/shower

## 24 Crew toilet/shower

Tecma toilet 24v  
Washbasin  
Shower with door  
Mirror on bulkhead  
Halogen overhead lighting 24v  
Shaver socket 240/110v  
Extractor fan  
Door to crew area



1. Foredeck sunpad
2. The Sunseeker 90 Yacht at anchor
3. Forward flybridge
4. Hydraulic bathing platform
5. Main saloon
6. View along the side deck
7. Owner's stateroom
8. Aft cockpit
9. Bathing platform set at lower level

## 25 Aft starboard crew cabin

Twin bunk berths with foam mattresses  
Air-conditioning  
Halogen overhead lighting 24v  
Double AC socket  
Reading light 24v  
Fitted carpet  
Sensor connected to fire detection system  
Telephone point (outboard shelf)  
Opening porthole with mosquito screen and curtains  
Door to crew mess

## 26 Forward starboard crew cabin

Twin bunk berths with foam mattresses  
Air-conditioning  
Halogen overhead lighting 24v  
Double AC socket  
Reading light 24v  
Fitted carpet  
Sensor connected to fire detection system  
Telephone point (outboard shelf)  
Opening porthole with mosquito screen and curtains  
Door to crew mess

## 27 Engine compartment and ancillaries

Separate fuel filters with water alarms  
Automatic fire extinguisher with engine/generator  
and fan shutdown  
1 x automatic bilge pump (in each watertight  
compartment)  
1 x automatic flood pump (in each watertight  
compartment)  
2 x extractor fans AC  
Manual bilge pump  
24v socket  
Sensor connected to fire detection system  
Lighting (AC & DC)

## 28 Electrical system

European specification only: 2 x 23kW slow speed  
Kohler generators with underwater silent exhaust  
USA specification only: 2 x 28kW slow speed Kohler  
generators with underwater silent exhaust  
Dockside AC connection (1 x 100amp  
Glendinning cablemaster)  
24v and 12v DC electrical system with full circuit  
breaker protection  
4 x engine batteries 24v circuit  
8 x domestic batteries 24v circuit  
2 x generator batteries 12v circuit  
Alternator split charging system  
Remote battery switches controlled from locker  
in cockpit  
2 x 95amp battery chargers for 24v circuit  
1 x 20amp battery charger for 12v circuit  
2 x 2kW immersion heaters for calorifier  
AC sockets throughout the boat  
Fire detection system with monitoring panel  
in wheelhouse

## 29 Underwater gear

5-blade NAB bronze propellers  
Bronze P-brackets  
Stainless steel Temet 25 shafts  
Dripless shaft logs with spare seals  
High-performance bronze rudders and struts  
Seawater strainers x 2 main engines and generators  
Seacocks on all underwater fittings  
Full cathodic bonding system to zinc anodes  
Hydraulic bow thruster (30hp)  
Hydraulic stern thruster (30hp)  
Hydraulic trim tabs  
Antifouling

## 30 Systems

Hydraulic power steering on gearbox  
Tecma toilets (24v) with control (incorporating tank  
level indication)  
Toilets discharging overboard or to black-water tank  
Black waste-water tank (454 litres/120 US gal)  
discharging to dockside or overboard (24v)  
macerator pump  
Washbasins, showers, air-conditioning fan units  
discharging to grey waste sump  
Grey waste-water sump with overboard discharge (24v)  
Fresh-water tank with electric sending unit  
AC fresh-water pump  
Hot water circulating pump  
2 x 150 litre calorifiers, each with 2 x 2kW immersion  
heaters  
Chilled water air-conditioning system (reverse cycle)

## 31 Miscellaneous

Toolkit  
Boat hook  
6 x mooring ropes  
8 x fenders  
Vacuum cleaner  
Spare bulbs and fuses  
1 set of towels per person

## USA specification includes:

Upgraded generators  
US Coast Guard build regulations  
US specification appliances

\*Every attempt has been made to give accurate information, but performance and range figures are estimates given as a guide only. Dirt or growth on the hull, tuning of the engines, size, make of engines fitted, damage to propellers, the temperature of the air and water, the weight of fuel, water, stores, number of people, propeller pitch, quality of fuel and other matters, can all affect a boat's performance and range. For these and other reasons we can give no performance, range or other guarantees, and neither such guarantees nor anything contained herein constitutes an offer of contract or any representation or agreement, or may otherwise be relied upon. The photographs and artist's impressions in this brochure are of existing models in the Sunseeker range. There may be items shown in these photographs and artist's impressions that are not included in the standard inventory of the models shown. Specifications contained on the web site are samples only and should not be relied upon and may refer to models only intended for sale in a particular territory and not generally. No guarantee is given that any model will be available in any territory; however by contacting us we can advise you of models that are likely to be available in each territory.

Actual specifications will be provided when a sales order or enquiry is placed with us or our approved Sunseeker dealer. Specifications for models sold in different markets may vary and specifications and models may be changed or withdrawn at any time without prior notice. The individual specification for each vessel will be agreed as part of the sale contract between the purchaser and the Sunseeker dealer. Dealers and distributors are independently owned and operated entities, and therefore Sunseeker dealers and distributors are not owned by Sunseeker International Limited or any subsidiaries or other related entity of this company nor are they their agents. Therefore they have absolutely no authority to commit Sunseeker International Limited, or any subsidiary or other related entities of Sunseeker International Limited to any pledge, contract or agreement in any form or by any means unless first accepted in writing by Sunseeker International Limited. In some examples herein Sunseeker have referred to measurements, specifications or other details applicable to a particular territory and no guarantee is given that these are applicable to your territory. For ease of reference we have, in some cases, referred to "we" or "Sunseeker" and these terms should be taken to mean Sunseeker International Limited.



**Krüger Werft AG**  
**Ländlistrasse 28**  
**CH-8274 Gottlieben**  
**Tel. +41(0)71 6691269**  
**info@krueger-werft.ch**

#### Awards

Sunseeker's success over the years is clearly underlined by the following list of national and international awards and achievements.

2008	UK Motor Boat of the Year Awards 2008	Manhattan 60	2001	Best Power Interior Award	105 Yacht, The Superyacht Society
2007	European Powerboat of the Year	Superhawk 43	2001	President's Award	Southern California Marine Association
2007	Asia Pacific Boating Awards	90 Yacht, Best of the Best	2000	Queen's Award for Enterprise	Continuous innovation and development
2007	Modern Boating Magazine 2007	Portofino 47, Imported Powerboat of the Year	2000	The Times Exporter of the Year	Times Export Awards
2007	Australian Marine Industries Federation Awards	Predator 62, Imported Powerboat of the Year	2000	Robb Report Award	Best of the Best, Boating and Sailing
2007	Nominated by The Superyacht Society	37 Metre Yacht 'The Snapper'	1999	Robb Report Award	Best of the Best, Boating and Sailing
2007	Queen's Award for Enterprise	International Trade	1999	Motorboat of the Year	Predator 75, BT British Nautical Awards
2006	Nominated for three Superyacht Awards	Predator 108 'SHIVER'	1998	Superyacht Design Award	Manhattan 74, Superyacht Design Awards
2005	Australian Marine Industries Federation Awards	75 Yacht, Non-Trailable Boat Award	1998	Editor in Chief Awards	Yachts Magazine
2005	Australian Marine Industries Federation Awards	Portofino 46, Commendation	1997	Lifetime Achievement Award	Robert Braithwaite MBE, RYA Awards
2005	Modern Boating, Power Boat of the Year Awards	Predator 68, Imported Powerboat of the Year	1996	Motorcruiser of the Year Award	RYA British Nautical Awards
2005	Boats.com Marine Industry Web Awards	Manufacturers Category for www.sunseeker.com	1996	Exporter of the Year Award	DCCI Export Awards
2004	Sydney Boat Show 2004	Best Overall Display	1995	Boat Builder of the Year Award	RYA/BMIF British Nautical Awards
2004	Sydney Boat Show 2004	Best Marina Display	1994	Queen's Award for Export Achievement	Queen's Awards for Industry
2003	Australian Marine Awards	Manhattan 56, Award for Excellence	1992	Best in the World Award	Renegade 60, Boating Magazine
2003	Australian Marine Awards	Predator 68, Best Imported Non-Trailable Yacht	1990	Exporter of the Year	SW International Business Awards
2002	Entrepreneur of the Year Award	Robert Braithwaite MBE	1989	Queen's Award for Export Achievement	Queen's Awards for Industry
2001	Best Power Design Award	105 Yacht, The Superyacht Society	1987	Queen's Award for Export Achievement	Queen's Awards for Industry

#### Naval architects

Don Shead/Sunseeker Design

#### Exterior styling

Sunseeker Design

#### Interior design

Sunseeker Design

#### Builder

Sunseeker International

\*Every attempt has been made to give accurate information, but performance and range figures are estimates given as a guide only. Dirt or growth on the hull, tuning of the engines, size, make of engines fitted, damage to propellers, the temperature of the air and water, the weight of fuel, water, stores, number of people, propeller pitch, quality of fuel and other matters, can all affect a boat's performance and range. For these and other reasons we can give no performance, range or other guarantees, and neither such guarantees nor anything contained herein constitutes an offer of contract or any representation or agreement, or may otherwise be relied upon. The photographs and artist's impressions in this brochure are of existing models in the Sunseeker range. There may be items shown in these photographs and artist's impressions that are not included in the standard inventory of the models shown. Specifications contained on the web site are samples only and should not be relied upon and may refer to models only intended for sale in a particular territory and not generally. No guarantee is given that any model will be available in any territory; however by contacting us we can advise you of models that are likely to be available in each territory. Actual specifications will be provided when a sales order or enquiry is placed with us or our approved Sunseeker dealer. Specifications for models sold in different markets may vary and specifications and models may be changed or withdrawn at any time without prior notice. The individual specification for each vessel will be agreed as part of the sale contract between the purchaser and the Sunseeker dealer. Dealers and distributors are independently owned and operated entities, and therefore Sunseeker dealers and distributors are not owned by Sunseeker International Limited or any subsidiaries or other related entity of this company nor are they their agents. Therefore they have absolutely no authority to commit Sunseeker International Limited, or any subsidiary or other related entities of Sunseeker International Limited to any pledge, contract or agreement in any form or by any means unless first accepted in writing by Sunseeker International Limited. In some examples herein Sunseeker have referred to measurements, specifications or other details applicable to a particular territory and no guarantee is given that these are applicable to your territory. For ease of reference we have, in some cases, referred to "we" or "Sunseeker" and these terms should be taken to mean Sunseeker International Limited.

Designed, written and produced by Marketing Matters Limited. Printed in England. August 2008. ©Sunseeker International.



Sunseeker International Limited has  
CE Approval which is compulsory  
for all boats with a LOA of 24m and  
below when sold in the EU.