



PORTOFINO 48



*The world's finest luxury motoryachts*



## SUNSEEKER PORTOFINO 48

STYLE: SPORTS CRUISER

ACCOMMODATION: UP TO 4 GUESTS

PERFORMANCE: UP TO 30 KNOTS

A very smart surrogate for the preceding Portofino 47, this newcomer – with just a smidgeon extra in length – has achieved a remarkable step up in interior plan. Where once there was the classic main suite in the bow and a cross-beam twin cabin aft of the saloon, the Portofino 48 has a remarkable full-beam owner's suite aft, with huge windows to either side, while forward there's a clever new VIP suite in which the central double bed cunningly swings apart to create twin single berths for a family or just-friends combination.



The central saloon with mostly cupboard-concealed galley sits at the heart of the accommodation and shares the same high-style interior design detailing with mix of grain, bold lacquers and deep glass options reflected in the sleeping cabins and the handsomely fitted en suites.

So where has the extra space come from? Sunseeker has again innovated with a new take on design that matches optimisation of accommodation without undue effect on performance which derives, here, from a choice of twin props or pod drives which make manoeuvring so simple. Point the joystick where you want to park and the Portofino virtually follows that line.



38



SUNSEEKER PORTOFINO 48

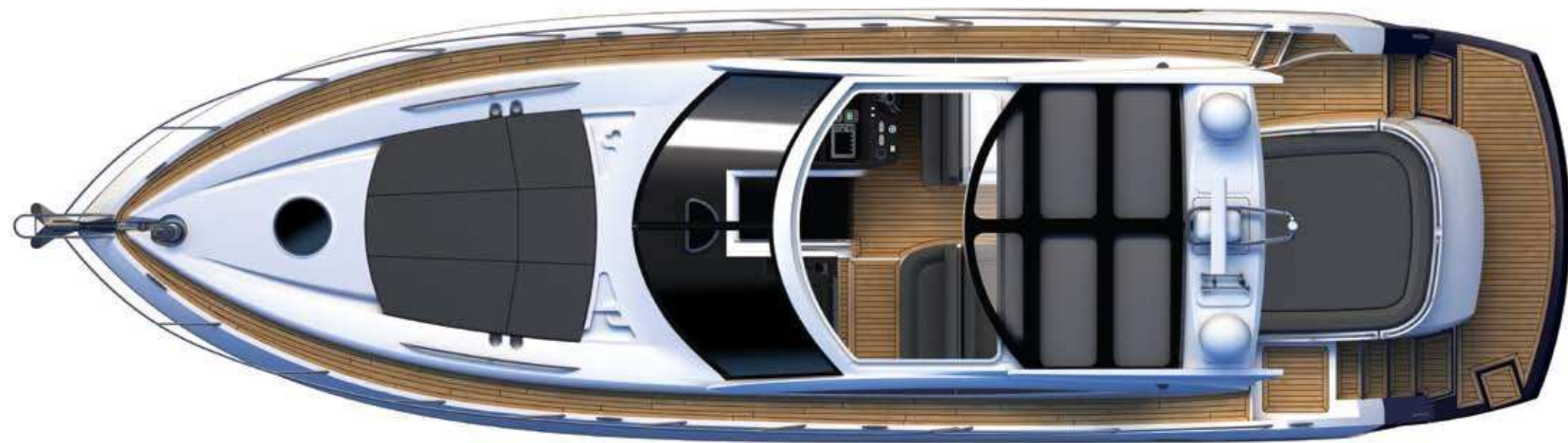



Externally, the profile is sleek with a long expanse of foredeck topped by cantilevering sunpads that incline lazars for an easier view of the panorama. Looking back, the cockpit screen rises fairly well aft in a smooth and neatly engineered radius, behind which is found an electronically well supported helm station with companion as well as pilot seating, a wetbar and full dining arrangement. And a trademark sunpad extends slightly over the submersible bathing platform that doubles as tender slip.

SUNSEEKER PORTOFINO 48





42



There's the choice of open or hard top versions, the former with bimini and tonneau cover, the latter with rigid sliding section to open or close according to shade requirements or weather conditions.

A new Portofino but, as ever, for all occasions.

## SUNSEEKER PORTOFINO 48

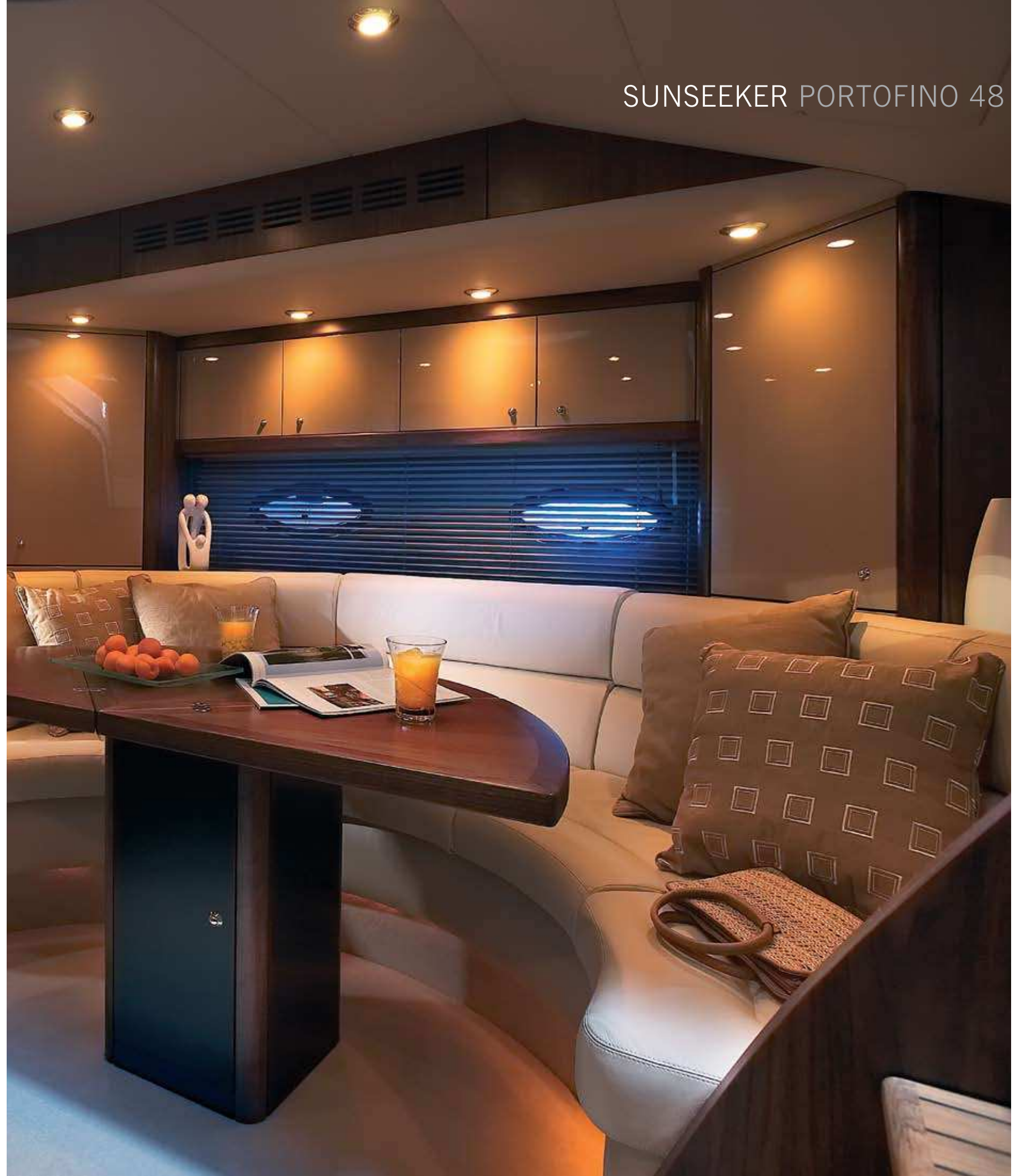

# SUNSEEKER PORTOFINO 48

STANDARD LAYOUTS

Main deck

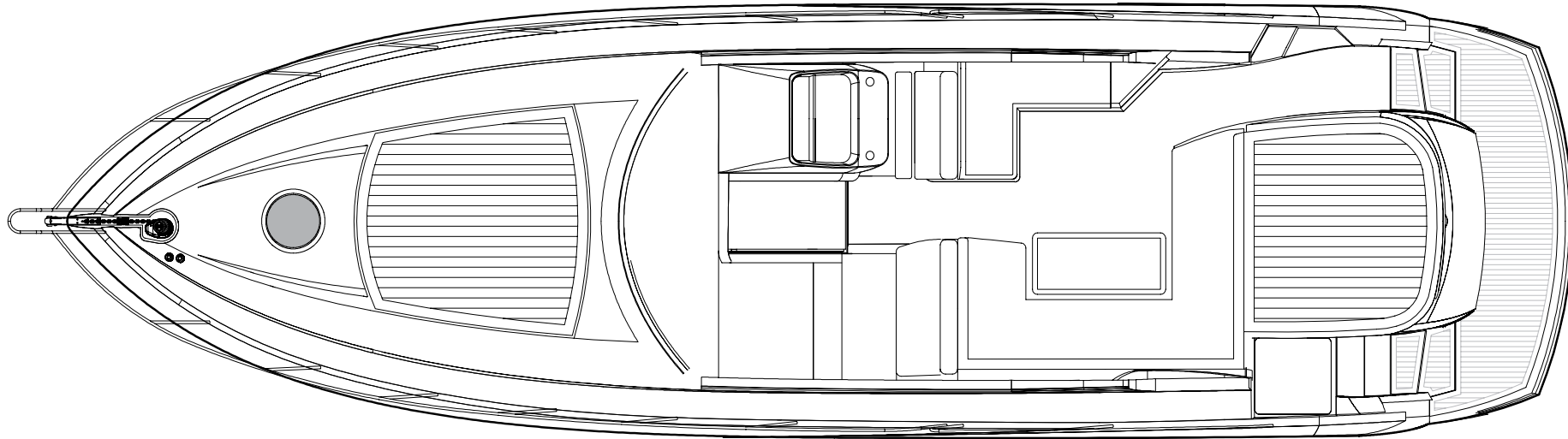

44

Lower deck

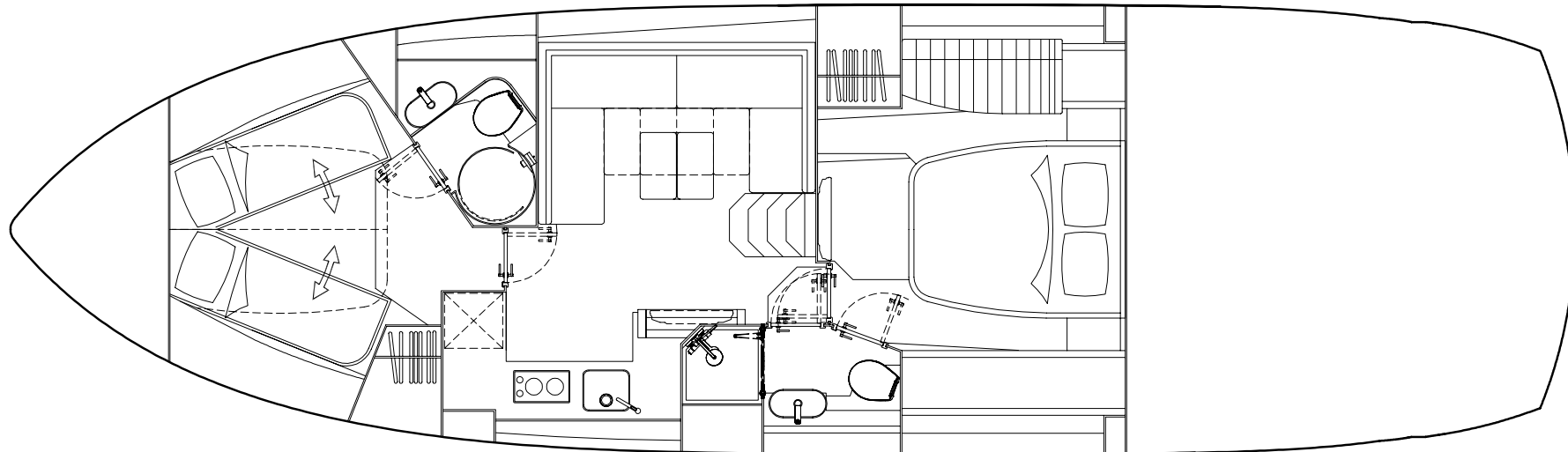

# PRINCIPAL CHARACTERISTICS

## PRINCIPAL CHARACTERISTICS – PROVISIONAL

Classification	CE (Cat B)/MCA <24m		
Length overall – fixed platform – (incl. pulpit)	15.39m	50'6"	
Length overall – lifting platform – (incl. pulpit)	15.96m	52'4"	
Length waterline – (@ half load)	11.21m	36'9"	
Beam – (maximum incl. rubbing strake)	4.30m	14'1"	
Height overall	4.32m	14'2"	
Draft – (maximum @ full load, incl. gear)	1.30m	4'3"	
Displacement – (@ full load)	17065kg	37622lb	
Fuel capacity	1320 litres	290 GB gal.	349 US gal.
Fresh-water capacity	340 litres	75 GB gal.	90 US gal.
Propulsion	Pod Drive		
Engine options	up to 1150 PS (total)		
Fuel options	Diesel		
Generators	Standard	4.5kW @ 50Hz (Euro) 10kW @ 60Hz (US)	
	Optional upgrade	13kW @ 50Hz (Euro) Up to 10kW @ 60Hz (US)	
Maximum speed	up to 36 knots*		
Cruising speed	30 knots*		

All principal characteristics and specifications are provisional.



# SUNSEEKER PORTOFINO 48

## PRINCIPAL FEATURES – PROVISIONAL

Electric anchor winch with deck and cockpit controls  
Hot and cold swimming shower  
Full wetbar with hot and cold water  
Coolbox  
Large cockpit table  
Depth sounder  
VHF radio  
Flatscreen television in all cabins  
DVD player in saloon  
Radio/CD  
Electric refrigerator  
Electric hob and microwave  
Hot and cold water system  
Automatic fire extinguishers  
Automatic bilge pump  
Radar  
Autopilot  
Generator  
Teak bathing platform and step  
AC shorepower/battery charger  
Vacuum toilets and holding tank

All items included in standard specification.

US specification includes:

Air conditioning  
Upgraded generator  
US Coast Guard build regulations  
US specification appliances

For full specification visit [www.sunseeker.com](http://www.sunseeker.com)

## SPECIFICATION – PROVISIONAL

### 1 Construction

Hand-laid GRP  
Gel coat including stripes  
Vinylester skin coat with powderbound mat  
Stitched multi-axial reinforced single skin bottom  
Balsa cored hull topsides  
PVC foam cored deck and superstructure  
Hull stiffened with longitudinal stringers supported by transverse bulkheads and floors

### 2 Deck

Moulded non-slip deck finish  
Fittings all in stainless steel  
Pulpit and cockpit rails  
Stainless steel fendering with rubber insert  
10 stainless steel cleats  
Electric anchor winch and capstan with deck and cockpit controls  
Stainless steel bow roller with anchor stop  
Delta anchor and 30m chain (galvanised)  
Chain locker with fender storage  
IMCO navigation lights  
Fuel filler  
Fresh water filler  
Foldaway swimming ladder  
Teak-laid bathing platform and steps  
Hot and cold swimming shower  
Ensign staff and socket  
Fender tie bar under anchor locker lid

### 3 Cockpit

Self draining  
Safety door  
Full wetbar with hot and cold water and coolbox  
Dinette seating  
Fold-out table  
Storage beneath seating  
Folding helm seat  
Co-pilot seating area  
Chart table  
Large stern sunbather over garage space  
Glass holders  
Overhead cockpit lights 12v  
Low-level cockpit lights  
Waterproof carpet

### 4 Helm Console

Console with burr type walnut fascia  
Radar  
Autopilot  
VHF radio  
Leather and Chrome steering wheel  
Single lever controls  
Full analogue engine instrumentation  
Electronic speedlog  
Depth sounder  
Fuel gauge  
Fresh water gauge  
Compass  
Horn  
Trim tab controls  
Waterproof plug and socket  
2 windscreen wipers and washers  
Fire extinguisher  
Glass holders

### 5 Main Cabin/Saloon

Large folding dinette  
Flatscreen television  
DVD player  
Radio/CD with speakers for the cockpit  
Stowage beneath seats  
Drinks cupboard  
Overhead halogen lights 12v  
Opening portholes with mosquito screens and curtains  
Deck hatch  
Main switch and circuit breaker panel (AC/DC)  
Double AC socket  
Choice of lacquered interior finishes and veneers  
Scatter cushions  
Fitted carpet

### 6 Galley

Electric refrigerator  
Electric twin hob  
Microwave  
Hot and cold water  
6 place crockery set  
6 place cutlery set  
Cupboard storage and drawers  
Opening porthole with mosquito screen and blind  
Double AC socket  
Hand-held fire extinguisher  
First aid kit  
Rubbish bin

### 7 Master Aft Stateroom

Double bed  
Storage beneath  
Drawers in bed end  
2 x reading lights 12v  
Hanging wardrobe  
Overhead halogen lighting  
Large side windows and curtains  
Chaise longue  
Door to toilet/shower  
Double AC socket  
Flatscreen television  
Fitted carpet

### 8 Master En Suite Toilet and Bathroom

Wash basin  
Taps and accessories  
Hot and cold water  
Mirrored vanity unit  
Toothbrush glass holder  
Soap dish  
Towel ring  
Stowage cupboard  
Vacuum toilet  
Shower compartment  
Overhead lights  
Opening porthole with mosquito screen and curtain  
Razor socket 240/110v

# PRINCIPAL FEATURES & SPECIFICATION

## 9 Twin Forward Cabin

Two single V berths to swing and make double  
Under-berth storage  
Hanging wardrobe  
Storage cupboard  
Deck hatch  
Overhead halogen lighting  
2 x reading lights  
Opening porthole with mosquito screen  
Double AC socket  
Flatscreen television  
Fitted carpet

## 10 En Suite Toilet Compartment

Wash basin  
Taps and accessories  
Hot and cold water  
Mirrored vanity unit  
Toothbrush glass holder  
Soap dish  
Towel ring  
Shower  
Overhead lights  
Vacuum toilet  
Opening porthole with mosquito screen and curtain  
Razor socket 240/110v

## 11 Engine Compartment and Ancillaries

Soundproofing throughout  
Fuel filters/water separator to engines & generators  
FM200 Manual/Auto  
Fire Exit System  
Automatic bilge & flood pumps with high level alarms  
Air extraction fans- 24v  
Generator exhaust silencers and water separators  
Engine exhaust dry risers and water injection  
Strainers to all raw water materials

## 12 Electrical System

Slow speed generator with underwater silent exhaust system  
AC dockside connection  
Galvanic isolator  
24v DC electrical system with full circuit breaker protection  
4 x engine batteries  
4 x domestic batteries  
2 x generator batteries  
Alternator split charging system  
Battery switches controlled from locker in cockpit  
Battery charger  
Water heater  
AC sockets throughout the boat

## 13 Underwater Gear

Direct drive shaft through tunnels  
NAB 5 Blade propellers  
Bronze (AB2) –P-Brackets  
Stainless steel – Temet 25 – propeller shafts  
Self aligning shaft seal c/w spare seal  
High performance bronze rudder and struts  
Valves to all underwater skin fittings  
Sea water strainers to engines and generators  
Full cathodic bonding system to zinc anodes  
Stainless steel trim tabs.

## 14 Systems

Electric toilet system – 24v  
Aluminium freshwater tank  
GRP fuel tank  
Fresh water pressure system – 24v  
Calorifier – 240v  
Grey water stump box & discharge pump – 24v  
Bilge pump system  
FM200 Manual/Auto  
Fire Exit System  
Auxiliary hydraulics – 24v  
Hydraulic power steering

## 15 Miscellaneous

2 sets towels  
2 x mooring warps  
6 x fenders

## 16 Optional Extras

Opening hard top  
Air conditioning  
Upgraded generator  
Teak cockpit  
Bow thruster  
Electric lifting platform

## US Spec includes:

Air-conditioning  
Upgraded generator  
US Coast Guard build Regulations  
US Specification appliances





**Krüger Werft AG**  
**Ländlistrasse 28**  
**CH-8274 Gottlieben**  
**Tel. +41(0)71 6691269**  
**info@krueger-werft.ch**

**Awards**

Sunseeker's success over the years is clearly underlined by the following list of national and international awards and achievements.

2008	UK Motor Boat of the Year Awards 2008	Manhattan 60	2001	Best Power Interior Award	105 Yacht, The Superyacht Society
2007	European Powerboat of the Year	Superhawk 43	2001	President's Award	Southern California Marine Association
2007	Asia Pacific Boating Awards	90 Yacht, Best of the Best	2000	Queen's Award for Enterprise	Continuous innovation and development
2007	Modern Boating Magazine 2007	Portofino 47, Imported Powerboat of the Year	2000	The Times Exporter of the Year	Times Export Awards
2007	Australian Marine Industries Federation Awards	Predator 62, Imported Powerboat of the Year	2000	Robb Report Award	Best of the Best, Boating and Sailing
2007	Nominated by The Superyacht Society	37 Metre Yacht 'The Snapper'	1999	Robb Report Award	Best of the Best, Boating and Sailing
2007	Queen's Award for Enterprise	International Trade	1999	Motorboat of the Year	Predator 75, BT British Nautical Awards
2006	Nominated for three Superyacht Awards	Predator 108 'SHIVER'	1998	Superyacht Design Award	Manhattan 74, Superyacht Design Awards
2005	Australian Marine Industries Federation Awards	75 Yacht, Non-Trailable Boat Award	1998	Editor in Chief Awards	Yachts Magazine
2005	Australian Marine Industries Federation Awards	Portofino 46, Commendation	1997	Lifetime Achievement Award	Robert Braithwaite MBE, RYA Awards
2005	Modern Boating, Power Boat of the Year Awards	Predator 68, Imported Powerboat of the Year	1996	Motorcruiser of the Year Award	RYA British Nautical Awards
2005	Boats.com Marine Industry Web Awards	Manufacturers Category for www.sunseeker.com	1996	Exporter of the Year Award	DCCI Export Awards
2004	Sydney Boat Show 2004	Best Overall Display	1995	Boat Builder of the Year Award	RYA/BMIF British Nautical Awards
2004	Sydney Boat Show 2004	Best Marina Display	1994	Queen's Award for Export Achievement	Queen's Awards for Industry
2003	Australian Marine Awards	Manhattan 56, Award for Excellence	1992	Best in the World Award	Renegade 60, Boating Magazine
2003	Australian Marine Awards	Predator 68, Best Imported Non-Trailable Yacht	1990	Exporter of the Year	SW International Business Awards
2002	Entrepreneur of the Year Award	Robert Braithwaite MBE	1989	Queen's Award for Export Achievement	Queen's Awards for Industry
2001	Best Power Design Award	105 Yacht, The Superyacht Society	1987	Queen's Award for Export Achievement	Queen's Awards for Industry

**Naval architects**

Sunseeker Design

**Exterior styling**

Sunseeker Design

**Interior design**

Sunseeker Design/Design Unlimited

**Builder**

Sunseeker International

\*Every attempt has been made to give accurate information, but performance and range figures are estimates given as a guide only. Dirt or growth on the hull, tuning of the engines, size, make of engines fitted, damage to propellers, the temperature of the air and water, the weight of fuel, water, stores, number of people, propeller pitch, quality of fuel and other matters, can all affect the boat's performance and range. For these and other reasons we can give no performance, range or other guarantees, and neither such guarantees nor anything contained herein constitutes an offer of contract or any representation or agreement, or may otherwise be relied upon. The photographs and artist's impressions in this document are of existing models in the Sunseeker range. There may be items shown in these photographs and artist's impressions that are not included in the standard inventory of the models shown. Specifications contained on the web site are samples only, should not be relied upon, and may refer to models only intended for sale in a particular territory and not generally. No guarantee is given that any model will be available in any territory; however by contacting us we can advise you of models that are likely to be available in each territory. Actual specifications will be provided when a sales order or enquiry is placed with us or our approved Sunseeker dealer. Specifications for models sold in different markets may vary and specifications and models may be changed or withdrawn at any time without prior notice. The individual specification for each vessel will be agreed as part of the sale contract between the purchaser and the Sunseeker dealer. Dealers and distributors are independently owned and operated entities, and therefore Sunseeker dealers and distributors are not owned by Sunseeker International Limited or any subsidiaries or other related entity of this company nor are they their agents. Therefore they have absolutely no authority to commit Sunseeker International Limited, or any subsidiary or other related entities of Sunseeker International Limited to any pledge, contract or agreement in any form or by any means unless first accepted in writing by Sunseeker International Limited. In some examples herein Sunseeker have referred to measurements, specifications or other details applicable to a particular territory and no guarantee is given that these are applicable to your territory. For ease of reference we have, in some cases, referred to "we" or "Sunseeker" and these terms should be taken to mean Sunseeker International Limited.

The photographs shown in this brochure are not of the Predator 60, Predator 54 and Portofino 48 but are representative of the colour, quality and finish provided.

Designed, written and produced by Marketing Matters Limited. Printed in Italy, August 2009. ©Sunseeker International.