



PREDATOR 54



*The world's finest luxury motoryachts*



## SUNSEEKER PREDATOR 54

STYLE: PERFORMANCE MOTORYACHT

ACCOMMODATION: UP TO 6 GUESTS

PERFORMANCE: UP TO 33 KNOTS

Very much an owner's boat, the Predator 54 has been designed for simplicity in operation yet encompassing systems reflecting the higher levels of sophistication. The styling is hot and so is the performance. And if you seek shade as well as sun there's the choice of open or hard top, the former having fold out bimini and tonneau covers, the latter an automated sliding roof between screen and rear section.



Looking at the cockpit plan with wetbar, dining area, expansive sunpad and companion seating, it's easy to think the emphasis is on outdoor living, but step below and the extent of the contemporary design detailing and depth of comfort proves a tempting draw. Open plan in essence, the saloon and galley set the pattern well with insets and highlights in the wall panelling and cabinetry that's finished in a mix of grain and bold lacquer and coloured glass tops. The theme continues through all the guest cabins, the master suite forward in the bow and the twin and Pullman cabins aft which each also have their own flatscreen television and ample storage for clothing and effects – always an important point with Sunseeker.

24

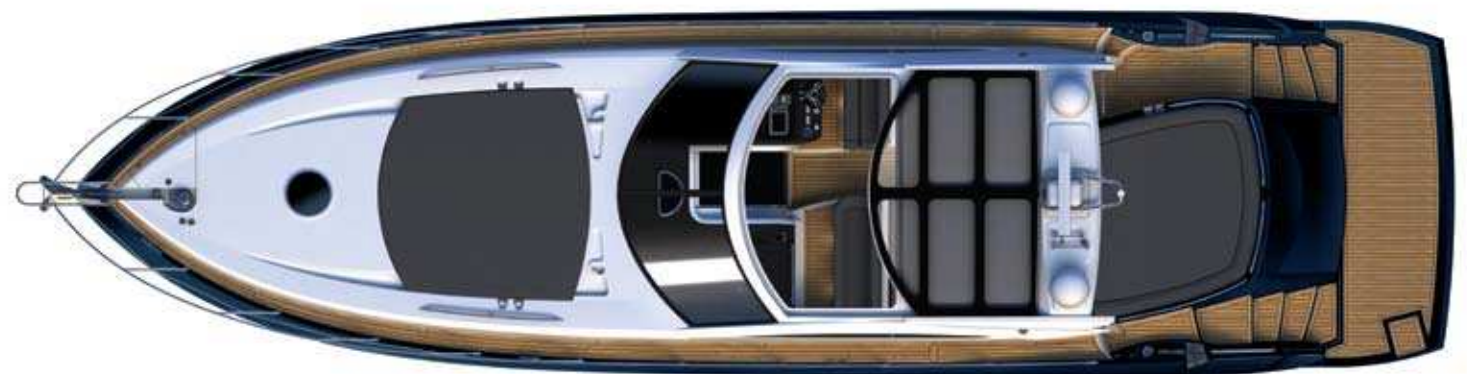

SUNSEEKER PREDATOR 54





Hotel services are catered for by the genset fitted as standard, so there's no issue with you running refrigeration and air conditioning while at anchor. When zipping between moorings, cruising is fuel efficient at 27 knots while, with the top option of twin 800 PS diesels, 33 knots is within easy reach.



# SUNSEEKER PREDATOR 54





Nipping ashore is made simple too.  
The tender sits on a neat roller arrangement  
in the stern-opening garage and an automated  
system makes light of launching and retrieving.

It's that ease in operation that adds  
to overall performance.

## SUNSEEKER PREDATOR 54



# SUNSEEKER PREDATOR 54

STANDARD LAYOUTS

Main deck

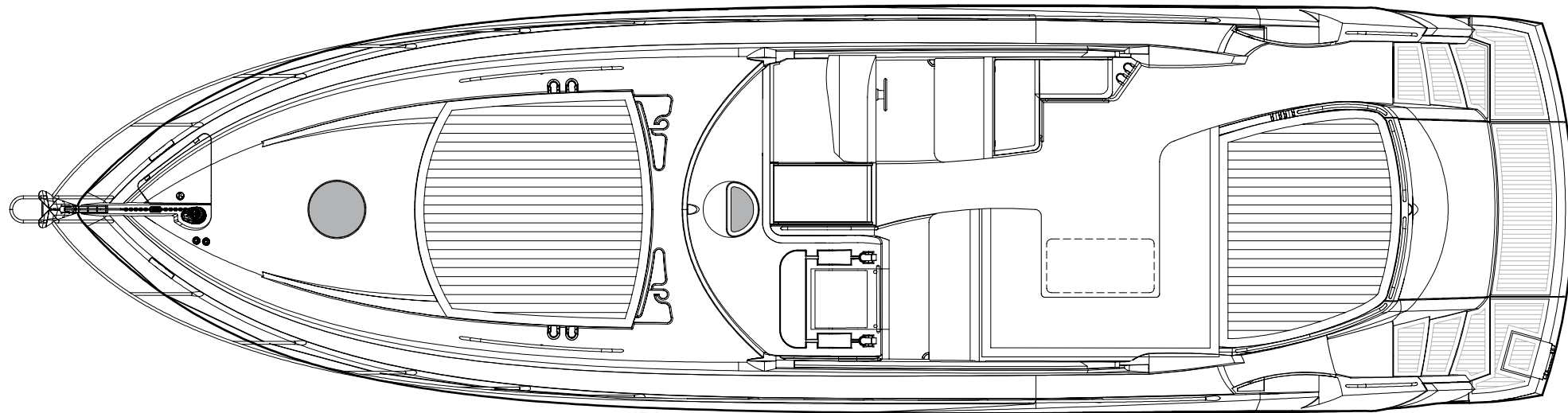

30

Lower deck

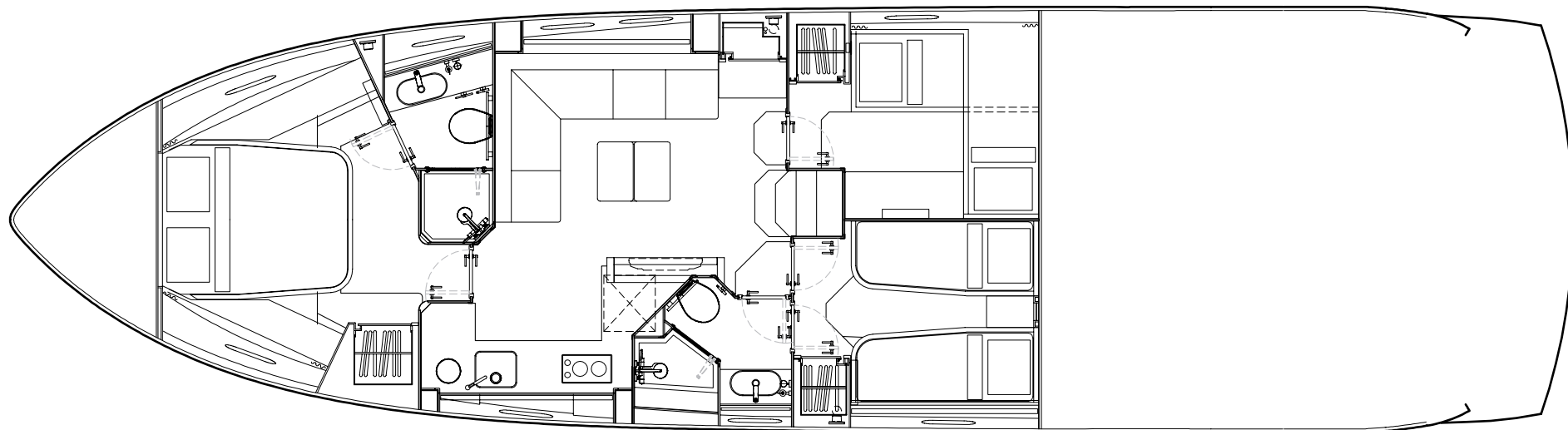

# PRINCIPAL CHARACTERISTICS

## PRINCIPAL CHARACTERISTICS – PROVISIONAL

Classification	CE (Cat B)/MCA <24m		
Length overall – fixed platform – (incl. pulpit)	17.45m	57'3"	
Length overall – lifting platform – (incl. pulpit)	17.76m	58'3"	
Length waterline – (@ half load)	13.19m	43'3"	
Beam – (maximum)	4.54m	14'11"	
Draft – (maximum @ full load, incl. gear)	1.38m	4'6"	
Height overall	4.52m	14'10"	
Displacement – (@ full load)	25400kg	55997lbs	
Fuel capacity	2500 litres	550 GB gal.	661 US gal.
Fresh-water capacity	500 litres	110 GB gal.	132 US gal.
Propulsion options	Twin shaft and Pod Drive		
Engine options	up to 1730 PS (total)		
Generators	Standard	9kW @ 50Hz (Euro)	13kW @ 60Hz (US)
	Optional upgrade	13kW @ 50Hz (Euro)	Up to 15.5kW @ 60Hz (US)
Max speed	up to 32 knots*		
Cruising speed	27 knots*		

All principal characteristics and specifications are provisional.



# SUNSEEKER PREDATOR 54

## PRINCIPAL FEATURES – PROVISIONAL

Garage to house tender  
Electric anchor winch with deck and cockpit controls  
Hot and cold swimming shower  
Full wetbar with hot and cold water  
Top loading ice chest  
Cockpit table  
Camper/suntop and tonneau cover  
Electronic speedlog  
Depth sounder  
VHF radio  
Flatscreen televisions in each cabin  
DVD player in saloon  
Radio/CD player  
Electric refrigerator  
Electric hob and microwave  
Hot and cold water system  
Automatic fire extinguishers  
Automatic bilge pump  
Radar  
Autopilot  
Generator  
Teak bathing platform and step  
AC shorepower/battery charger  
Antifouling

All items included in standard specification.

### US specification includes:

Air conditioning  
Upgraded generator  
US Coast Guard build regulations  
US specification appliances

For full specification visit [www.sunseeker.com](http://www.sunseeker.com)

## SPECIFICATION – PROVISIONAL

### 1 Construction

Hand-laid GRP  
Gel coat including stripes  
Vinylester skin coat with powderbound mat  
Stitched multi-axial reinforced single skin bottom  
Balsa cored hull topsides  
PVC foam cored deck and superstructure  
Hull stiffened with longitudinal stringers supported by transverse bulkheads and floors

### 2 Deck

Fittings all in stainless steel  
Pulpit and cockpit rails  
Stainless steel fendering with rubber insert  
8 x stainless steel cleats  
Curved stainless steel framed safety glass windscreen  
Stainless steel bow roller with anchor stop  
Stainless steel bow plate  
Delta anchor and 45m chain (galvanised)  
Electric winch and capstan with deck and cockpit controls 24v  
IMCO navigation lights  
Ensign staff and socket  
Fender tie bar under anchor locker lid

### 3 Bathing Platform

Teak-laid bathing platform and steps  
Hot and cold swimming shower  
Fresh water marina connection  
Dockside AC shore power connection  
Stainless steel swimming ladder

### 4 Cockpit

Self draining  
Safety door  
Full wetbar with hot and cold water  
Top loading ice chest  
Deeply upholstered seating for up to 8 around cockpit table  
Foldaway cockpit table  
Lockers beneath seating  
Aft sunbather  
Garage with hydraulic opening door to house optional tender  
Glass holders  
Overhead cockpit lights 24v  
Low-level cockpit lights 24v  
Waterproof carpet

### 5 Helm Console

Folding helm seat  
Chart area  
Contoured console with burr type walnut fascia  
Single lever engine controls  
Radar  
Autopilot system  
Hydraulic steering  
Wood rimmed steering wheel  
Full analogue engine instrumentation  
Electronic speedlog  
Depth sounder  
Fresh water gauge  
Fuel gauge  
Steering indicator  
VHF radio  
Compass  
Horn  
Trim tab controls  
Waterproof plug and socket 12v  
2 x windscreen wipers and washers  
Fire extinguisher  
Glass holders

### 6 Main Cabin/Saloon

Large dinette  
Flatscreen television  
DVD player  
Radio/CD with speakers in cabin and cockpit  
Stowage beneath seats  
Drinks cupboard  
Halogen overhead lights 24v  
Opening portholes with mosquito screens  
Deck hatch  
Main switch and circuit breaker panel (AC/DC)  
Double AC socket  
Choice of lacquered interior finishes and veneers  
Scatter cushions  
Fitted carpet

### 7 Galley

Electric refrigerator 24v  
Electric hob and microwave  
Double AC socket  
Hot and cold water  
6 place crockery set  
6 place cutlery set  
Cupboards and drawers  
Opening porthole with mosquito screen and blind  
Hand-held fire extinguisher  
First aid kit  
Rubbish bin

### 8 Master Stateroom

Double berth  
Storage and drawers beneath  
Hanging wardrobe with mirrored door  
Overhead storage lockers  
Flatscreen television  
Halogen overhead lighting  
2 x reading lights  
2 x opening portholes with mosquito screen and curtains  
Deck hatch with mosquito screen  
Double AC socket  
Door to toilet/shower room  
Fitted carpet

### 9 Master En Suite Shower Room And Toilet

Vacuum toilet  
Wash basin with taps and accessories  
Hot and cold water  
Separate shower compartment  
Acrylic shower door  
Razor socket 240/110v  
Mirrored cupboard  
Towel rails  
Halogen overhead lights  
Opening porthole with curtain

### 10 Port Aft Cabin

2 x single berths with storage beneath  
Bedside cabinet with drawer  
Hanging wardrobe  
Flatscreen television  
Halogen overhead lights  
2 x reading lights  
Opening porthole with mosquito screen  
Single AC socket  
Door to en suite shower room  
Fitted carpet

### 11 En Suite And Day Head

Vacuum toilet  
Wash basin with taps and accessories  
Hot and cold water  
Separate shower compartment  
Acrylic shower door  
Razor socket 240/110v  
Mirrored cupboard  
Towel rails  
Halogen overhead lighting  
Opening porthole with curtain

# PRINCIPAL FEATURES & SPECIFICATION

## 12 Starboard Aft Cabin

2 x Pullman type berths with storage locker beneath  
Hanging wardrobe  
Side storage cabinet  
Flatscreen television  
Halogen overhead lighting  
2 x reading lights  
Opening porthole with mosquito screen  
Single AC socket  
Fitted carpet

## 13 Engine Compartment And Ancillaries

Soundproofing throughout  
Fuel filters/water separator to engines and generators  
FM200 Manual/Auto Fire Ext System  
Automatic bilge and flood pumps with high level alarms  
Air extraction fans – 24v  
Generator exhaust silencers and water separators  
Engine exhaust dry risers and water injection  
Strainers to all raw water inlets

## 14 Electrical System

Slow speed generator with underwater silent exhaust  
AC dockside connection  
Galvanic isolator  
24v DC electrical system with full circuit breaker protection  
4 x engine batteries 24v circuit  
2 x domestic batteries 12/24v circuit  
1 x generator batteries 12v circuit  
Alternator split charging system  
Battery switches controlled from locker in cockpit  
Battery charger for 24v circuits  
Battery charger for 12v circuits  
Water heater  
AC sockets throughout the boat

## 15 Underwater Gear

Direct drive shaft through tunnels  
NAB 5 Blade propellers  
Bronze (AB2) – P-Brackets  
Stainless steel – Temet 25 – propeller shafts  
Self aligning shaft seal c/w spare seal  
High performance bronze rudder and struts  
Valves to all underwater skin fittings  
Sea water strainers to engines and generators  
Full cathodic bonding system to zinc anodes  
Stainless steel trim tabs

## 16 Systems

Electric toilet system – 24v  
Aluminium freshwater tank  
Aluminium fuel tank  
Fresh water pressure system – 24v  
Calorifier – 240v  
Grey water stump box and discharge pump – 24v  
Bilge pump system  
FM200 Manual/Auto Fire Exit System  
Auxiliary hydraulics – 24v  
Hydraulic power steering

## 17 Miscellaneous

2 sets towels  
4 x mooring warps  
6 x fenders

## 18 Optional Extras

Hydraulic hard top  
Air conditioning  
Upgraded generator  
Teak cockpit  
Bow thruster  
Hydraulic Lifting Platform

## US Specification includes:-

Air-conditioning  
Upgraded generator  
US Coast Guard build Regulations  
US Specification appliances

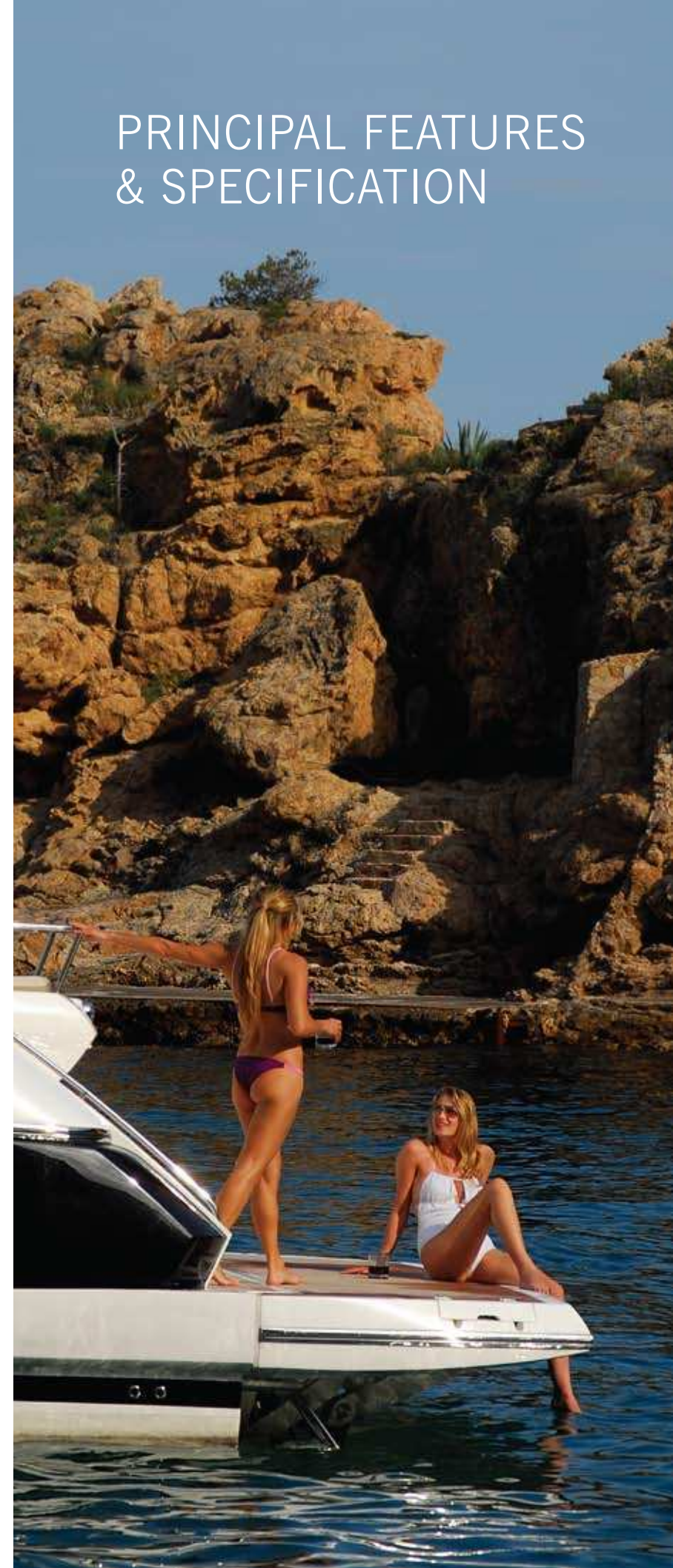



**Krüger Werft AG**  
**Ländlistrasse 28**  
**CH-8274 Gottlieben**  
**Tel. +41(0)71 6691269**  
**info@krueger-werft.ch**

**Awards**

Sunseeker's success over the years is clearly underlined by the following list of national and international awards and achievements.

2008	UK Motor Boat of the Year Awards 2008	Manhattan 60	2001	Best Power Interior Award	105 Yacht, The Superyacht Society
2007	European Powerboat of the Year	Superhawk 43	2001	President's Award	Southern California Marine Association
2007	Asia Pacific Boating Awards	90 Yacht, Best of the Best	2000	Queen's Award for Enterprise	Continuous innovation and development
2007	Modern Boating Magazine 2007	Portofino 47, Imported Powerboat of the Year	2000	The Times Exporter of the Year	Times Export Awards
2007	Australian Marine Industries Federation Awards	Predator 62, Imported Powerboat of the Year	2000	Robb Report Award	Best of the Best, Boating and Sailing
2007	Nominated by The Superyacht Society	37 Metre Yacht 'The Snapper'	1999	Robb Report Award	Best of the Best, Boating and Sailing
2007	Queen's Award for Enterprise	International Trade	1999	Motorboat of the Year	Predator 75, BT British Nautical Awards
2006	Nominated for three Superyacht Awards	Predator 108 'SHIVER'	1998	Superyacht Design Award	Manhattan 74, Superyacht Design Awards
2005	Australian Marine Industries Federation Awards	75 Yacht, Non-Trailable Boat Award	1998	Editor in Chief Awards	Yachts Magazine
2005	Australian Marine Industries Federation Awards	Portofino 46, Commendation	1997	Lifetime Achievement Award	Robert Braithwaite MBE, RYA Awards
2005	Modern Boating, Power Boat of the Year Awards	Predator 68, Imported Powerboat of the Year	1996	Motorcruiser of the Year Award	RYA British Nautical Awards
2005	Boats.com Marine Industry Web Awards	Manufacturers Category for www.sunseeker.com	1996	Exporter of the Year Award	DCCI Export Awards
2004	Sydney Boat Show 2004	Best Overall Display	1995	Boat Builder of the Year Award	RYA/BMIF British Nautical Awards
2004	Sydney Boat Show 2004	Best Marina Display	1994	Queen's Award for Export Achievement	Queen's Awards for Industry
2003	Australian Marine Awards	Manhattan 56, Award for Excellence	1992	Best in the World Award	Renegade 60, Boating Magazine
2003	Australian Marine Awards	Predator 68, Best Imported Non-Trailable Yacht	1990	Exporter of the Year	SW International Business Awards
2002	Entrepreneur of the Year Award	Robert Braithwaite MBE	1989	Queen's Award for Export Achievement	Queen's Awards for Industry
2001	Best Power Design Award	105 Yacht, The Superyacht Society	1987	Queen's Award for Export Achievement	Queen's Awards for Industry

**Naval architects**

Sunseeker Design

**Exterior styling**

Sunseeker Design

**Interior design**

Sunseeker Design/Design Unlimited

**Builder**

Sunseeker International

\*Every attempt has been made to give accurate information, but performance and range figures are estimates given as a guide only. Dirt or growth on the hull, tuning of the engines, size, make of engines fitted, damage to propellers, the temperature of the air and water, the weight of fuel, water, stores, number of people, propeller pitch, quality of fuel and other matters, can all affect the boat's performance and range. For these and other reasons we can give no performance, range or other guarantees, and neither such guarantees nor anything contained herein constitutes an offer of contract or any representation or agreement, or may otherwise be relied upon. The photographs and artist's impressions in this document are of existing models in the Sunseeker range. There may be items shown in these photographs and artist's impressions that are not included in the standard inventory of the models shown. Specifications contained on the web site are samples only, should not be relied upon, and may refer to models only intended for sale in a particular territory and not generally. No guarantee is given that any model will be available in any territory; however by contacting us we can advise you of models that are likely to be available in each territory. Actual specifications will be provided when a sales order or enquiry is placed with us or our approved Sunseeker dealer. Specifications for models sold in different markets may vary and specifications and models may be changed or withdrawn at any time without prior notice. The individual specification for each vessel will be agreed as part of the sale contract between the purchaser and the Sunseeker dealer. Dealers and distributors are independently owned and operated entities, and therefore Sunseeker dealers and distributors are not owned by Sunseeker International Limited or any subsidiaries or other related entity of this company nor are they their agents. Therefore they have absolutely no authority to commit Sunseeker International Limited, or any subsidiary or other related entities of Sunseeker International Limited to any pledge, contract or agreement in any form or by any means unless first accepted in writing by Sunseeker International Limited. In some examples herein Sunseeker have referred to measurements, specifications or other details applicable to a particular territory and no guarantee is given that these are applicable to your territory. For ease of reference we have, in some cases, referred to "we" or "Sunseeker" and these terms should be taken to mean Sunseeker International Limited.

The photographs shown in this brochure are not of the Predator 60, Predator 54 and Portofino 48 but are representative of the colour, quality and finish provided.

Designed, written and produced by Marketing Matters Limited. Printed in Italy, August 2009. ©Sunseeker International.